

VersiColor RGB/RGBW Button Courtesy Light

Features

- Available in RGB or RGBW options
- RGB LEDs provide endless color options while the added white chip provides a high quality white
- The combination of RGB and White LEDs gives the user the ability to select a warmer or cooler white depending on preference.
- No fasteners required for installation
- Low profile & watertight
- Versatile LED light for varying applications
- Aesthetic collar available

Product Details

	RGB	RGBW
Housing	ABS Plastic	ABS Plastic
Diameter	1.25"	1.25"
Cutout	3/4" - Standard 1" - w/ Collar	3/4" - Standard 1" - w/ Collar
Wattage	0.7 W	1.0 W
Voltage:	10 - 14V DC	
Amp Draw:	0.05 A	0.07 A

Product Dimensions

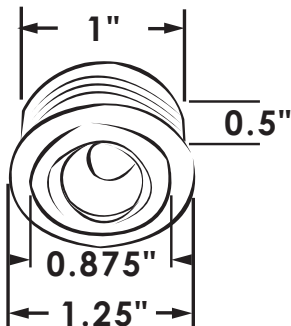

Specification Guide

Light Sample Part #: 69502CL-RGBW-3

Base Part
Lens Finish
LED Color
White LED Color

Button Light Specification

Base Part #	Lens Finish	LED Color	White LED Color
69502	CL - Clear DL - Diffused	RGBW - Red, Green, Blue & White RGB - Red, Green, Blue	3 - 3000K 6 - 6500K <i>*if RGB leave blank</i>

Collar Sample Part #: 69501A-CH

Base Part
Aesthetic Collar Color

Collar Specification

Base Part #	Aesthetic Collar
69501A	CH - Chrome NI - Brushed Nickel W4 - White



Shown with 69501A-NI collar



69502-RGB