







Refresh Shower Light Installation Instructions

(Part #: 69870-KK-FF)

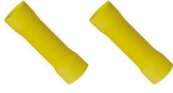
PARTS/TOOLS NEEDED:

			
Shower Light	Three #8 Pan Head Screws (not provided)	Butt Splice Connectors (not provided)	Power Drill (not provided)

IMPORTANT SAFETY INSTRUCTIONS. READ CAREFULLY FOR YOUR PROTECTION AND SAVE ALL INSTRUCTIONS.

- Disconnect power before installing, adding or changing any component.
- To avoid a hazard to children, account for all parts and destroy all packing materials.
- It is recommended that fuse protection be added to the positive (+) input.

1. Determine the installation location for your light and drill a ½" hole. Pull the units wiring through and wire using the diagram at the right. Screw in the light using three #8 pan head screws¹. Install gasket on decorative bezel, ensuring it is attached evenly². Snap bezel in place, making sure to line up the three tabs³.

2. Wire the light following the wiring diagrams below.

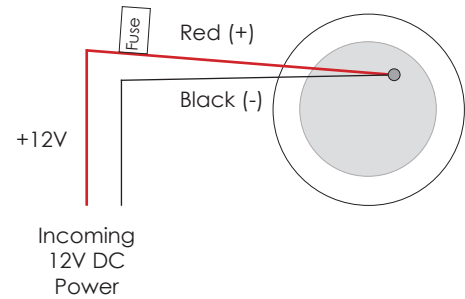
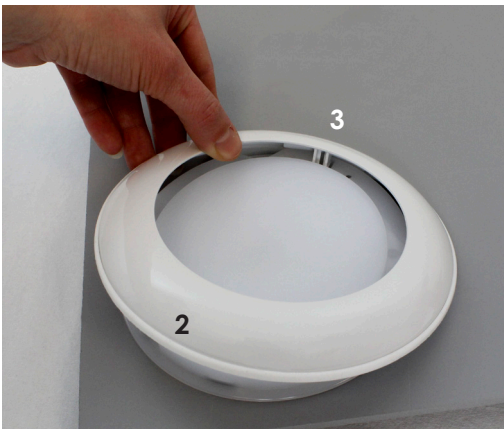

For warranty information please visit www.itc-us.com/warranty

3030 Corporate Grove Dr • Hudsonville • MI • 49426

Phone: 616-396-1355 • www.itc-us.com • sales@itc-us.com • DOC #: 710-00177 • Rev A • 11/17/20